

# Refraction unit BETA Master



BETA Master



## Refraction unit BETA Master

MB01T – model with elevating table top and fixed height chair.

MB01C – model with fixed height table top and elevating chair.

MB01CT – model with both elevating chair and table top.

- The vertical movement of the chair and table is adjustable from the integrated touch panel and / or from the foot – switch (optional)
- Column with overhead LED lamp with adjustable illumination
- Column with support for chart projector
- Integrated adjustable power transformers for slit lamp/ophthalmometer
- Chin rest support plate
- 230V outlet for additional instrument e.g. auto lensmeter, auto phoropter, etc.

## Optional

- Removable chair for wheelchair access
- Phoropter arm
- Foot rest (fixed or tip-up or tube type)
- Arm rests (fixed or tip-up or tip-up w.chair upholstery)
- Chair with manual or motorized reclining back
- Manual (13cm) or motorized (14cm) chair sliding forward – backwards
- Foot switch control for up/down movement of the chair or table
- Installed data cables (Fire Wire, USB, RS232, etc.)
- “Liftboy assistant” – height correcting system
- Room light controller
- Pillow for children
- Left-handed version
- Shelf for junction box with decorative panels
- Drawer for trial lenses set
- Doctor’s desk
- Cabinet on castors with drawers
- Stand for operational panel of digital phoropter

# BETA Master

1. Built-in panel with ambient light.



3. Column with LED lamp.



2. Drawer for trial lenses set.



## Technical information

Voltage	-115/230V 50/60Hz
Max height	200 cm
Table height from the ground	From $\pm$ 73cm to 98cm (25cm lift)
Chair height from the ground*	From $\pm$ 48cm to 63cm (15cm lift)
Overhead LED lamp	LED module 20V 700mA
Instruments power supply	-115/230V, programmable 3-17V AC or DC, dimmable or permanent

Max weight of the instruments (1st - 2nd) 20kg - 20kg

\*Varies depending on options

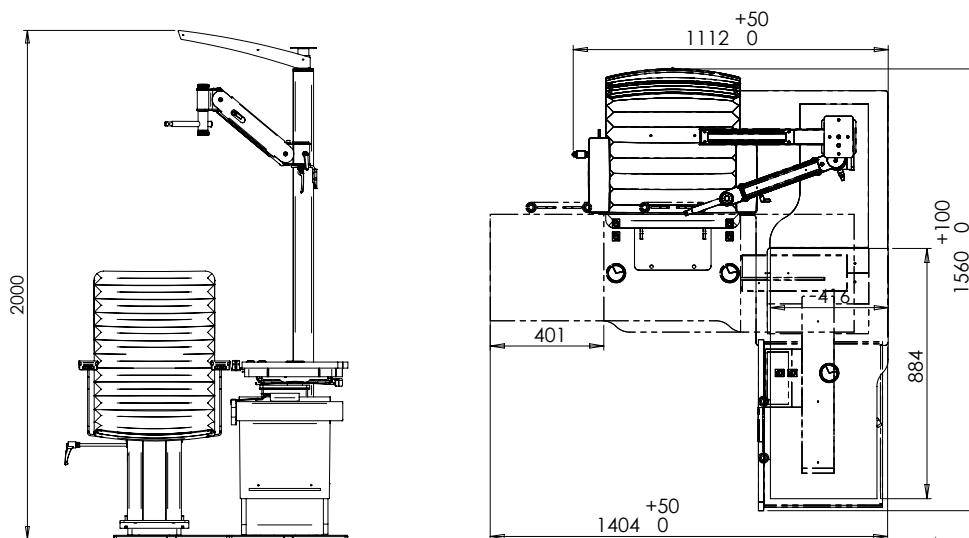

BETA Master

\*Varies depending on options

[sales@graftonoptical.com](mailto:sales@graftonoptical.com)/ 01923 233980